

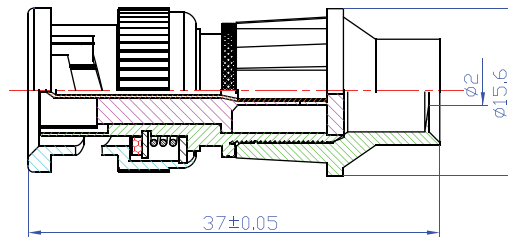

PRODUCT DATASHEET

KBM-HQ

CaP System
BNC MALE CONNECTOR
HIGH QUALITY: R. L. > 30 dB



Use these Tools

Stripping Dimension:

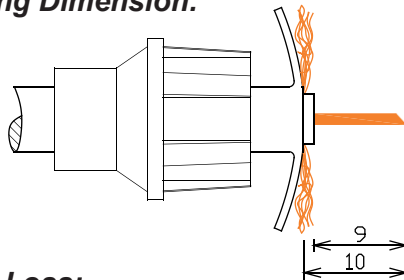

Return Loss:

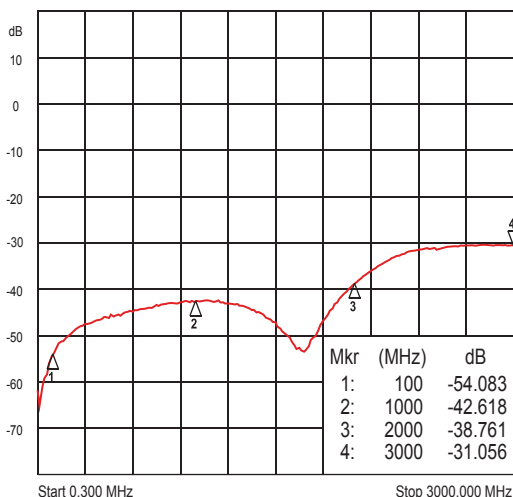

Suitable for Cables:

RG6 quad, RG6, RG59, RG178, ... suitable for all cable with inner conductor from Ø 0,3 up to Ø 1,1 mm (from AWG 28 to AWG 18)

Electrical Specification

Impedance: 75 Ohm
 Frequency: 0-3 GHz
 Return Loss: > 30 db @ 3 GHz
 Dielectric W/V: 500 Veff
 Insulation res: 5000 M-Ohm
 Screening Immunity: Class A+

Mechanical Specification

Body Material: Brass - Gold plated
 Center Contact: Beryllium Copper - Gold plat.
 Insulator: HDPE
 Bayonet Cap: Zinc - Black Nickel plated
 Gasket: Rubber
 Washer: Fe - Nickel plated
 Spring: SK5 - Nickel plated
 Inner Retaining Ring: Fe - Nickel plated
 CaP®: Protected Plastic Compound
 Weight: 9.8 g

Environmental Specification

Operating Temp: - 40 ÷ + 120 °C

How to use the ProCaP

- ① Slide CaP on to cable.

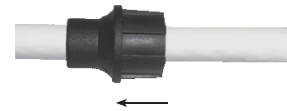

- ② Insert the cable to the side hole of the SPC, about 1 cm.

Holding the stripper tool in the palm of your hand, squeeze blades together and pull cable out cutting both sides of the outer sheath.

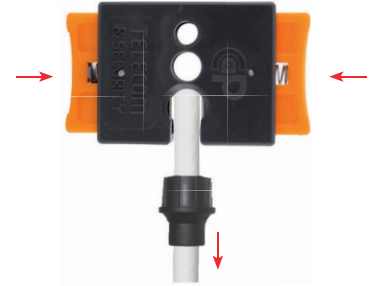

- ③ Expose centre dielectric by bearing back the sheath and shield.



- ④ Expose the copper core, by using the last hole on the stripper tool. Insert centre dielectric flush with the body of the stripper tool, twist and press blades together. This will enable you to remove the dielectric, exposing the copper core.

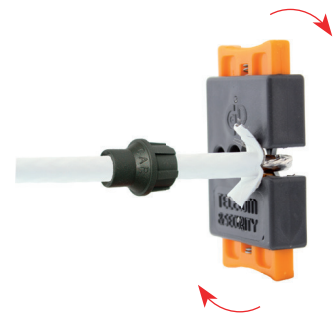

- ⑤ Push the exposed copper core into the F female connector, slide the sheath and shield over the thread and slide the CaP to the start of the F connector.

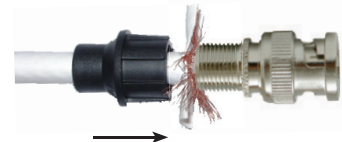

- ⑥ Insert the specific groove of the connector on to the rights de fork, as in figure, and compress the CaP over the connector using the ProCaP.

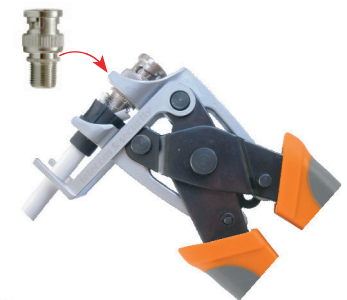

- ⑦ To remove the CaP insert the groove of the connector in the middle fork.

Press the ProCaP and the separator will remove the CaP.

